

CHATHAM COUNTY PURCHASING & CONTRACTING DEPARTMENT

ADDENDUM NO. 1 TO 19-0060-4

**FOR: COOPERATIVE EXTENSION SERVICE REHABILITATION**

---

---

**PLEASE SEE THE FOLLOWING FOR ADDITIONS, CLARIFICATIONS AND/OR CHANGES:**

1. **REPLACE CURRENT *SPECIFICATION SECTION 07 54 19 PVC ROOFING* WITH THE ATTACHED REVISED SPECIFICATION SECTION 07 54 19 PVC ROOFING ( 10 sheets)**
2. **ADD DRAWINGS: *PP-01 Plot Plan* ( 1 sheet)  
*Sheet LSI.01 Life Safety Composite Floor Plan* (1 sheet)  
*Sheet AO.01, Gen. Project Notes, Graphic Symbols & Abbreviations* (1 sheet)**
3. **REPLACE T1.0 Coversheet Drawing with the ATTACHED REVISED Coversheet (1 sheet)**

---

---

**NOTE: BID OPENING REMAINS:  
2PM, THURSDAY, JULY 11, 2019**

---

---

**THE PROPOSER IS RESPONSIBLE FOR MAKING THE NECESSARY CHANGES AND MUST ACKNOWLEDGE RECEIPT OF ADDENDUM.**

6/27/19  
DATE



---

ROBERT E. MARSHALL  
SENIOR PROCUREMENT SPECIALIST  
CHATHAM COUNTY

## ADDENDUM NO. 1

DATE: June 27, 2019

PROJECT: Chatham County Cooperative Extension Service Rehabilitation  
Board of Commissioners, Chatham County, Georgia

BY: COGDELL & MENDRALA ARCHITECTS, PC (Architect)  
517 East Congress Street  
Savannah, GA 31401

This Addendum forms a part of the Contract Documents and modifies the original Drawings and Project Manual dated April, 2019 and identified as Construction Documents.

1. SPECIFICATIONS:
  - a. Replace Section 07 54 19 Polyvinyl Chloride (PVC) Roofing with the attached Section 07 54 19 Polyvinyl Chloride (PVC) Roofing .
2. DRAWINGS:
  - a. Add Drawings,
    - i. PP-01 , Plot Plan
    - ii. Sheet LS1.01, Life Safety Composite Floor Plan
    - iii. Sheet A0.01, Gen. Project Notes, Graphic Symbols and Abbreviations
  - b. Replace Drawings:
    - i. T1.0 Coversheet

END OF ADDENDUM NO. 1

## SECTION 07 54 19 - POLYVINYL-CHLORIDE (PVC) ROOFING

### PART 1 - GENERAL

#### 1.1 RELATED DOCUMENTS

- A. Drawings and general provisions of the Contract, including General and Supplementary Conditions and Division 01 Specification Sections, apply to this Section.

#### 1.2 SUMMARY

- A. Section Includes:
  - 1. Mechanically fastened polyvinyl-chloride (PVC) roofing system.
  - 2. Roof insulation.
- B. Related Requirements:
  - 1. Section 01 22 000 "Unit Prices" for replacement of deteriorated existing sheathing.
  - 2. Section 061053 "Miscellaneous Rough Carpentry" for wood nailers, curbs, and blocking; and for wood-based, structural-use roof deck panels.
  - 3. Section 07 92 00 "Joint Sealants" for joint sealants, joint fillers, and joint preparation.

#### 1.3 DEFINITIONS

- A. Roofing Terminology: Definitions in ASTM D 1079 and glossary in NRCA's "The NRCA Roofing and Waterproofing Manual" apply to work of this Section.

#### 1.4 PREINSTALLATION MEETINGS

- A. Preinstallation Roofing Conference: Conduct conference at Project site.
  - 1. Meet with Owner, Architect, Owner's insurer if applicable, testing and inspecting agency representative, roofing Installer, roofing system manufacturer's representative, deck Installer, and installers whose work interfaces with or affects roofing, including installers of roof accessories and roof-mounted equipment.
  - 2. Review methods and procedures related to roofing installation, including manufacturer's written instructions.
  - 3. Review and finalize construction schedule, and verify availability of materials, Installer's personnel, equipment, and facilities needed to make progress and avoid delays.
  - 4. Examine deck substrate conditions and finishes for compliance with requirements, including flatness and fastening.
  - 5. Review structural loading limitations of roof deck during and after roofing.
  - 6. Review base flashings, special roofing details, roof drainage, roof penetrations, equipment curbs, and condition of other construction that affects roofing system.

7. Review governing regulations and requirements for insurance and certificates if applicable.
8. Review temporary protection requirements for roofing system during and after installation.
9. Review roof observation and repair procedures after roofing installation.

#### 1.5 ACTION SUBMITTALS

- A. Product Data: For each type of product.
- B. Shop Drawings: For roofing system. Include plans, elevations, sections, details, and attachments to other work, including:
  1. Base flashings and membrane terminations.
  2. Tapered insulation, including slopes.
  3. Insulation fastening patterns for corner, perimeter, and field-of-roof locations.
- C. Samples for Verification: For the following products:
  1. Sheet roofing, of color required.
  2. Applied ribs.

#### 1.6 INFORMATIONAL SUBMITTALS

- A. Qualification Data: For Installer and manufacturer.
- B. Manufacturer Certificates: Signed by roofing manufacturer certifying that roofing system complies with requirements specified in "Performance Requirements" Article.
  1. Submit evidence of compliance with performance requirements.
- C. Product Test Reports: For components of roofing system, for tests performed by manufacturer and witnessed by a qualified testing agency.
- D. Research/Evaluation Reports: For components of roofing system, from ICC-ES.
- E. Field quality-control reports.
- F. Sample Warranties: For manufacturer's special warranties.

#### 1.7 CLOSEOUT SUBMITTALS

- A. Maintenance Data: For roofing system to include in maintenance manuals.

#### 1.8 QUALITY ASSURANCE

- A. Manufacturer Qualifications: A qualified manufacturer that is UL listed or FM Global approved for roofing system identical to that used for this Project.

- B. Installer Qualifications: Installer Qualifications: A firm or individual experienced in installing, erecting, or assembling work similar in material, design, and extent to that indicated for this Project, whose work has resulted in construction with a record of successful in-service performance, and has been in business under the same name for more than ten years, and has been approved by the manufacturer of the product being installed. All work under this section must be approved employees of the approved applicator only. Foreman in charge of work shall have 10 years experience in successful installation of PVC roofing. Subcontracting of work under this section to lower tier subcontractors will not be allowed.**

#### 1.9 DELIVERY, STORAGE, AND HANDLING

- A. Deliver roofing materials to Project site in original containers with seals unbroken and labeled with manufacturer's name, product brand name and type, date of manufacture, approval or listing agency markings, and directions for storing and mixing with other components.
- B. Store liquid materials in their original undamaged containers in a clean, dry, protected location and within the temperature range required by roofing system manufacturer. Protect stored liquid material from direct sunlight.
  - 1. Discard and legally dispose of liquid material that cannot be applied within its stated shelf life.
- C. Protect roof insulation materials from physical damage and from deterioration by sunlight, moisture, soiling, and other sources. Store in a dry location. Comply with insulation manufacturer's written instructions for handling, storing, and protecting during installation.
- D. Handle and store roofing materials, and place equipment in a manner to avoid permanent deflection of deck.

#### 1.10 FIELD CONDITIONS

- A. Weather Limitations: Proceed with installation only when existing and forecasted weather conditions permit roofing system to be installed according to manufacturer's written instructions and warranty requirements.

#### 1.11 WARRANTY

- A. Special Warranty: Manufacturer agrees to repair or replace components of roofing system that fail in materials or workmanship within specified warranty period, No Dollar Limit. **Warranty shall include workmanship of Installer.****
  - 1. Special warranty includes membrane roofing, base flashings, fasteners, ~~attachment of ribs to membrane~~, and other components of roofing system. Warranty shall be edge to edge No Dollar Limit (NDL).
  - 2. Warranty Period: 20 years from date of Substantial Completion.
- B. Special Project Warranty: Submit roofing Installer's warranty, on warranty form at end of this Section, signed by Installer, covering the Work of this Section, including all components of roofing system such as membrane roofing, base flashing, roof insulation, fasteners, cover

boards, substrate boards, vapor retarders, roof pavers, and walkway products, for the following warranty period:

1. Warranty Period: Five years from date of Substantial Completion.

## PART 2 - PRODUCTS

### 2.1 MANUFACTURERS

- A. Source Limitations: Obtain components including roof insulation fasteners for roofing system from same manufacturer as membrane roofing or manufacturer approved by membrane roofing manufacturer.

### 2.2 PERFORMANCE REQUIREMENTS

- A. General Performance: Installed roofing and base flashings shall withstand specified uplift pressures, thermally induced movement, and exposure to weather without failure due to defective manufacture, fabrication, installation, or other defects in construction. Roofing and base flashings shall remain watertight.
  1. Accelerated Weathering: Roofing system shall withstand 2000 hours of exposure when tested according to ASTM G 152, ASTM G 154, or ASTM G 155.
  2. Impact Resistance: Roofing system shall resist impact damage when tested according to ASTM D 3746 or ASTM D 4272.
- B. Material Compatibility: Roofing materials shall be compatible with one another and adjacent materials under conditions of service and application required, as demonstrated by roofing manufacturer based on testing and field experience.
- C. Roofing System Design: Tested by a qualified testing agency to resist the following uplift pressures:
  1. As Indicated.
- D. Energy Star Listing: Roofing system shall be listed on the DOE's ENERGY STAR "Roof Products Qualified Product List".
- E. Exterior Fire-Test Exposure: ASTM E 108 or UL 790, Class A for application and roof slopes indicated; testing by a qualified testing agency. Identify products with appropriate markings of applicable testing agency.
- A. PVC Sheet: ASTM D 4434, Type III or Type IV, fabric reinforced.
  1. Manufacturers: Subject to compliance with requirements, available manufacturers offering products that may be incorporated into the Work include:
    - a. Duro-Last Roofing, Inc.
    - b. Johns Manville KEE; .
    - c. Sika Sarnafil S&G.
  2. Thickness: 60 mils minimum. Thinner membranes will not be acceptable.
  3. Exposed Face Color: White.

4. Provide felt backed membrane where indicated.

B. PVC Sheet: ASTM D 6754, fabric reinforced.

1. Seamans Corporation, FiberTite
2. Thickness: 45 mils..
3. Exposed Face Color: White.
4. Provide felt backed membrane where indicated.

## 2.3 AUXILIARY ROOFING MATERIALS

- A. General: Auxiliary materials recommended by roofing system manufacturer for intended use and compatible with roofing.
1. Liquid-type auxiliary materials shall comply with VOC limits of authorities having jurisdiction.
- B. Sheet Flashing: Manufacturer's standard PVC coated sheet flashing of same material, type, reinforcement, thickness, and color as selected by Architect.
- C. Bonding Adhesive: Manufacturer's standard.
- D. Metal Termination Bars: Manufacturer's standard, predrilled stainless-steel or aluminum bars, approximately **1 by 1/8 inch (25 by 3 mm)** thick; with anchors, with snap on covers of color selected by Architect.
- E. Fasteners: Factory-coated steel fasteners and metal or plastic plates complying with corrosion-resistance provisions in FM Global 4470, designed for fastening roofing to substrate, and acceptable to roofing system manufacturer.
- F. Miscellaneous Accessories: Provide pourable sealers, preformed cone and vent sheet flashings, preformed inside and outside corner sheet flashings, T-joint covers, lap sealants, termination reglets, and other accessories. Flashings to match membrane color.

## 2.4 ROOF INSULATION

- A. Polyisocyanurate Board Insulation: ASTM C 1289, Type II, Class 1, Grade 3, felt or glass-fiber mat facer on both major surfaces.
1. Provide product by manufacturer of roof membrane, or product by manufacturer approved in writing by membrane manufacturer.
- B. Provide Manufacturer's standard seam tape.

## 2.5 INSULATION ACCESSORIES

- A. General: Roof insulation accessories recommended by insulation manufacturer for intended use and compatibility with roofing.

- B. Fasteners: Factory-coated steel fasteners and metal or plastic plates complying with corrosion-resistance provisions in FM Global 4470, designed for fastening roof insulation to substrate, and acceptable to roofing system manufacturer.

## PART 3 - EXECUTION

### 3.1 EXAMINATION

- A. Examine substrates, areas, and conditions, with Installer present, for compliance with requirements and other conditions affecting performance of the Work:
  - 1. Verify that roof openings and penetrations are in place, curbs are set and braced, and roof-drain bodies are securely clamped in place.
  - 2. Verify that wood blocking, curbs, and nailers are securely anchored to roof deck at penetrations and terminations and that nailers match thicknesses of insulation.
  - 3. Verify surface plane flatness and fastening existing plywood deck.
  - 4. Replace deteriorated plywood deck panels as indicated under Section 01 22 00 "Unit Prices".
- B. Proceed with installation only after unsatisfactory conditions have been corrected.

### 3.2 PREPARATION

- A. Clean substrate of dust, debris, moisture, and other substances detrimental to roofing installation according to roofing system manufacturer's written instructions. Remove sharp projections.

Prevent materials from entering and clogging gutters and conductors and from spilling or migrating onto surfaces of other construction. .

### 3.3 ROOFING INSTALLATION, GENERAL

- A. Install roofing system according to roofing system manufacturer's written instructions.
- B. Complete terminations and base flashings and provide temporary seals to prevent water from entering completed sections of roofing system at end of workday or when rain is forecast. Remove and discard temporary seals before beginning work on adjoining roofing.

### 3.4 INSULATION INSTALLATION

- A. Coordinate installing roofing system components so insulation is not exposed to precipitation or left exposed at the end of the workday.
- B. Comply with roofing system and insulation manufacturer's written instructions for installing roof insulation.
- C. Where indicated, install tapered insulation under area of roofing to conform to slopes indicated.



- D. Install insulation under area of roofing to achieve required thickness. Where overall insulation thickness is **2.7 inches (68 mm)** or greater, install two or more layers with joints of each succeeding layer staggered from joints of previous layer a minimum of **6 inches (150 mm)** in each direction.
- E. Install insulation with long joints of insulation in a continuous straight line with end joints staggered between rows, abutting edges and ends between boards. Fill gaps exceeding **1/4 inch (6 mm)** with insulation.
  - 1. Cut and fit insulation within **1/4 inch (6 mm)** of nailers, projections, and penetrations.
- F. Mechanically Fastened Insulation: Install each layer of insulation and secure to deck using mechanical fasteners specifically designed and sized for fastening specified board-type roof insulation to deck type.
  - 1. Fasten insulation to resist uplift pressure at corners, perimeter, and field of roof.
- G. Tape joints between sheets of insulation with Joint Tape.

### 3.5 MECHANICALLY FASTENED ROOFING INSTALLATION

- A. Mechanically fasten roofing over area to receive roofing according to roofing system manufacturer's written instructions. Unroll roofing and allow to relax before retaining.
  - 1. Install sheet according to ASTM D 5082.
  - 2. For in-splice attachment, install roofing with long dimension perpendicular to steel roof deck flutes.
- B. Start installation of roofing in presence of roofing system manufacturer's technical personnel.
- C. Accurately align roofing, and maintain uniform side and end laps of minimum dimensions required by manufacturer. Stagger end laps.
- D. Mechanically fasten or adhere roofing securely at terminations, penetrations, and perimeter of roofing.
- E. Apply roofing with side laps shingled with slope of roof deck where possible.
- F. In-Seam Attachment: Secure one edge of PVC sheet using fastening plates or metal battens centered within seam, and mechanically fasten PVC sheet to roof deck.
- G. Seams: Clean seam areas, overlap roofing, and hot-air weld side and end laps of roofing and sheet flashings according to manufacturer's written instructions to ensure a watertight seam installation.
  - 1. Test lap edges with probe to verify seam weld continuity. Apply lap sealant to seal cut edges of sheet.
  - 2. Verify field strength of seams a minimum of twice daily, and repair seam sample areas.
  - 3. Repair tears, voids, and lapped seams in roofing that do not comply with requirements.
- H. Spread sealant bed over deck-drain flange at roof drains, and securely seal roofing in place with clamping ring.

3.6 BASE FLASHING INSTALLATION

- A. Install sheet flashings and preformed flashing accessories, and adhere to substrates according to roofing system manufacturer's written instructions.
- B. Apply bonding adhesive to substrate and underside of sheet flashing at required rate, and allow to partially dry. Do not apply to seam area of flashing.
- C. Flash penetrations and field-formed inside and outside corners with cured or uncured sheet flashing.
- D. Clean seam areas, overlap, and firmly roll sheet flashings into the adhesive. Hot-air weld side and end laps to ensure a watertight seam installation.
- E. Terminate and seal top of sheet flashings and anchor to substrate as indicated. Where termination bars contact existing copper flashing, provide stainless steel termination bars and fasteners.

3.7 FIELD QUALITY CONTROL

- A. Testing Agency: Owner will engage a qualified testing agency to inspect substrate conditions, surface preparation, membrane application, flashings, protection, and drainage components, and to furnish reports to Architect.
- B. Final Roof Inspection: Arrange for roofing system manufacturer's technical personnel to inspect roofing installation on completion.
- C. Repair or remove and replace components of roofing system where inspections indicate that they do not comply with specified requirements.
- D. Additional testing and inspecting, at Contractor's expense, will be performed to determine if replaced or additional work complies with specified requirements.
- E. Test cuts shall be made in locations as directed by Architect.

3.8 PROTECTING AND CLEANING

- A. Protect roofing system from damage and wear during remainder of construction period. When remaining construction does not affect or endanger roofing, inspect roofing for deterioration and damage, describing its nature and extent in a written report, with copies to Architect and Owner.
- B. Correct deficiencies in or remove roofing system that does not comply with requirements, repair substrates, and repair or reinstall roofing system to a condition free of damage and deterioration at time of Substantial Completion and according to warranty requirements.
- C. Clean overspray and spillage from adjacent construction using cleaning agents and procedures recommended by manufacturer of affected construction.
- D. At the end of one year from final acceptance, clean membrane per Manufacturer's written instructions.

- A. WHEREAS \_\_\_\_\_ of \_\_\_\_\_, herein called the "Roofing Installer," has performed roofing and associated work ("work") on the following project:
1. Owner: **<Insert name of Owner>**.
  2. Address: **<Insert address>**.
  3. Building Name/Type: **<Insert information>**.
  4. Address: **<Insert address>**.
  5. Area of Work: **<Insert information>**.
  6. Acceptance Date: \_\_\_\_\_.
  7. Warranty Period: **<Insert time>**.
  8. Expiration Date: \_\_\_\_\_.
- B. AND WHEREAS Roofing Installer has contracted (either directly with Owner or indirectly as a subcontractor) to warrant said work against leaks and faulty or defective materials and workmanship for designated Warranty Period,
- C. NOW THEREFORE Roofing Installer hereby warrants, subject to terms and conditions herein set forth, that during Warranty Period he will, at his own cost and expense, make or cause to be made such repairs to or replacements of said work as are necessary to correct faulty and defective work and as are necessary to maintain said work in a watertight condition.
- D. This Warranty is made subject to the following terms and conditions:
1. Specifically excluded from this Warranty are damages to work and other parts of the building, and to building contents, caused by:
    - a. lightning;
    - b. peak gust wind speed exceeding 63 mph.
    - c. fire;
    - d. failure of roofing system substrate, including cracking, settlement, excessive deflection, deterioration, and decomposition;
    - e. faulty construction of parapet walls, copings, chimneys, skylights, vents, equipment supports, and other edge conditions and penetrations of the work;
    - f. vapor condensation on bottom of roofing; and
    - g. activity on roofing by others, including construction contractors, maintenance personnel, other persons, and animals, whether authorized or unauthorized by Owner.
  2. When work has been damaged by any of foregoing causes, Warranty shall be null and void until such damage has been repaired by Roofing Installer and until cost and expense thereof have been paid by Owner or by another responsible party so designated.
  3. Roofing Installer is responsible for damage to work covered by this Warranty but is not liable for consequential damages to building or building contents resulting from leaks or faults or defects of work.
  4. During Warranty Period, if Owner allows alteration of work by anyone other than Roofing Installer, including cutting, patching, and maintenance in connection with penetrations, attachment of other work, and positioning of anything on roof, this Warranty shall become null and void on date of said alterations, but only to the extent said alterations affect work covered by this Warranty. If Owner engages Roofing Installer to perform said alterations, Warranty shall not become null and void unless Roofing Installer, before

starting said work, shall have notified Owner in writing, showing reasonable cause for claim, that said alterations would likely damage or deteriorate work, thereby reasonably justifying a limitation or termination of this Warranty.

5. During Warranty Period, if original use of roof is changed and it becomes used for, but was not originally specified for, a promenade, work deck, spray-cooled surface, flooded basin, or other use or service more severe than originally specified, this Warranty shall become null and void on date of said change, but only to the extent said change affects work covered by this Warranty.
6. Owner shall promptly notify Roofing Installer of observed, known, or suspected leaks, defects, or deterioration and shall afford reasonable opportunity for Roofing Installer to inspect work and to examine evidence of such leaks, defects, or deterioration.
7. This Warranty is recognized to be the only warranty of Roofing Installer on said work and shall not operate to restrict or cut off Owner from other remedies and resources lawfully available to Owner in cases of roofing failure. Specifically, this Warranty shall not operate to relieve Roofing Installer of responsibility for performance of original work according to requirements of the Contract Documents, regardless of whether Contract was a contract directly with Owner or a subcontract with Owner's General Contractor.

E. IN WITNESS THEREOF, this instrument has been duly executed this \_\_\_\_\_ day of \_\_\_\_\_, \_\_\_\_\_.

1. Authorized Signature: \_\_\_\_\_.
2. Name: \_\_\_\_\_.
3. Title: \_\_\_\_\_.

END OF SECTION 07 54 19



# CHATHAM COUNTY COOPERATIVE EXTENSION SERVICE REHABILITATION

GARDEN CITY, GEORGIA 31408  
FOR  
CHATHAM COUNTY BOARD OF COMMISSIONERS

PROJECT NO. 1823  
CONSTRUCTION DOCUMENTS

ARCHITECTS:  
MPE ENGINEER:

COGDELL & MENDRALA ARCHITECTS, PC  
SUSTAINABLE DESIGN CONSULTANTS



SCHEDULE OF DRAWINGS:

LIST OF DRAWINGS - LIFE SAFETY

LS1.01 LIFE SAFETY - COMPOSITE FIRST FLOOR PLAN

LIST OF DRAWINGS - ARCHITECTURAL

PP-01 PLOT PLAN  
D2.01 COMPOSITE DEMOLITION PLAN  
D2.11 ENLARGED DEMOLITION PLANS  
A0.01 GEN. PROJECT NOTES, GRAPHIC SYMBOLS, & ABBREVIATIONS  
A0.02 CONSTRUCTION SUBSYSTEMS & PARTITION TYPES, TBA MOUNTING  
A2.01 COMPOSITE FIRST FLOOR PLAN  
A2.03 ROOF PLAN  
A2.11 ENLARGED FLOOR PLANS  
A3.01 EXTERIOR ELEVATIONS  
A5.01 ENLARGED PLAN & INTERIOR ELEVATIONS  
A6.01 COMPOSITE FIRST FLOOR REFLECTED CEILING PLAN  
A6.11 ENLARGED REFLECTED CEILING PLANS  
A8.01 DOOR SCHEDULE, ELEVATIONS, AND DETAILS  
A8.31 ROOF DETAILS  
A8.41 EXTERIOR AND ROOF DETAILS  
A9.01 FINISH SCHEDULE & INTERIOR DETAILS  
A9.02 AREA B FINISH PLANS

LIST OF DRAWINGS - PLUMBING

P0.01 PLUMBING DETAILS, SCHEDULE, AND LEGEND  
P1.01 PLUMBING PLANS AND ISOMETRIC

LIST OF DRAWINGS - MECHANICAL

M0.01 HVAC SCHEDULES, SPECS, & LEGEND  
M1.01 HVAC PLANS AND NOTES  
M2.01 HVAC DETAILS

LIST OF DRAWINGS - ELECTRICAL

E1.00 ELECTRICAL LEGEND  
E1.01 LIGHTING PLAN  
E1.02 POWER PLAN

LOCATION MAP:

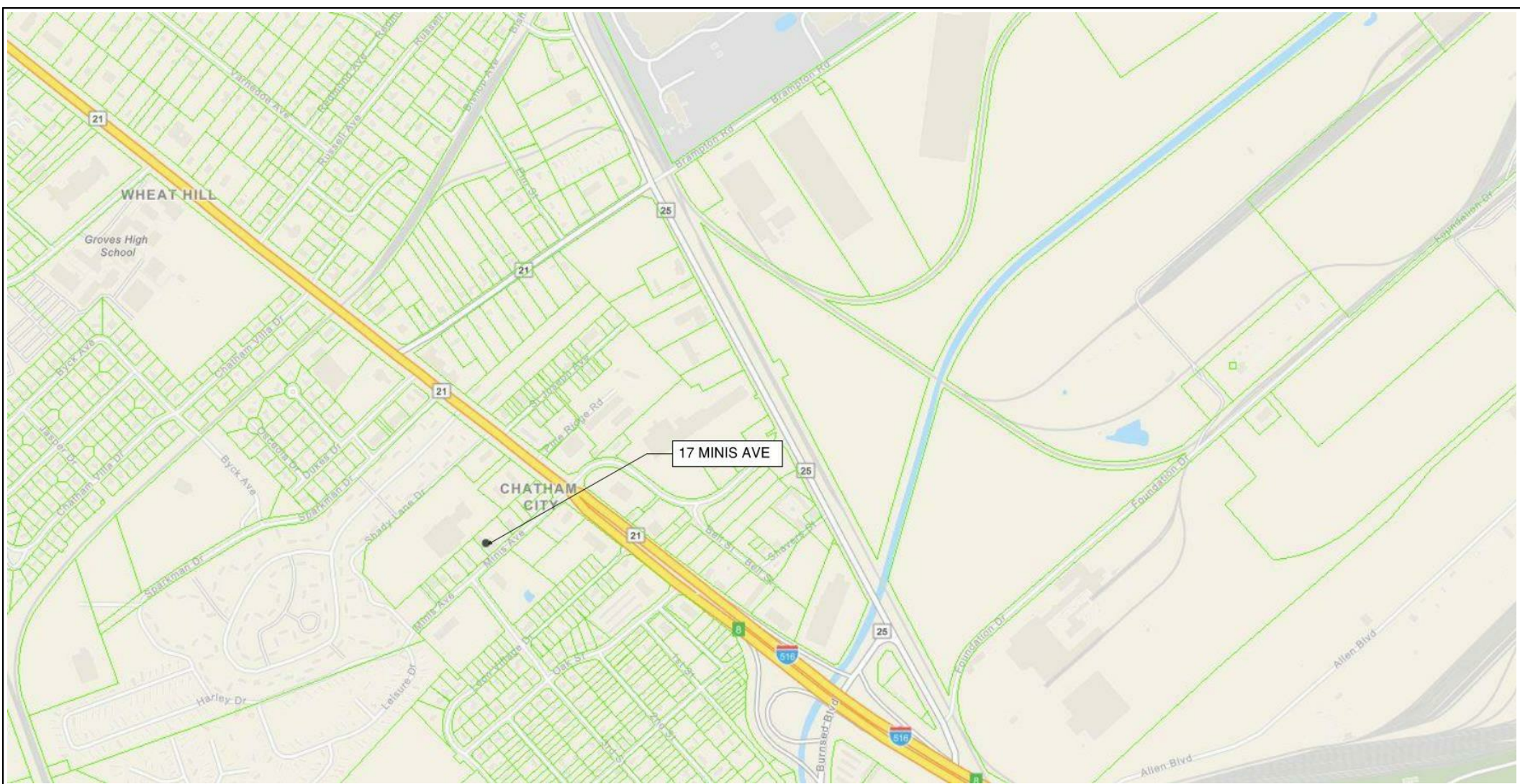

SHEET:

T1.0





OCCUPANCY LOAD SCHEDULE						
NAME	OCCUPANT USE GROUP	AREA	OCC. LOAD FACTOR	SQ. FT. TYPE	FIXED OCC. LOAD	OCCUPANT LOAD
PROPOSED RENOVATION "100"						
MECH. ELEC. DATA STORAGE	STORAGE/MECH.	871	300	GROSS	N/A	3
EDUCATION CENTER	CLASSROOM	599	20	NET	N/A	30
OFFICES	BUSINESS	391	100	GROSS	N/A	4
				PROPOSED RENOVATION "100" SUBTOTAL		37
EXISTING OFFICE "200"						
OFFICES	BUSINESS	5435	100	GROSS	N/A	47
CONFRENCE	ASSEMBLY	264	15	NET	N/A	18
MEETING ROOM	ASSEMBLY	507	15	NET	N/A	34
				EXISTING OFFICE "200" SUBTOTAL		99
				GRAND TOTAL		136
<u>NOTES:</u>						
a. NONE.						

PLUMBING FIXTURES (IBC TABLE 2902.1)														
MINIMUM REQUIRED PLUMBING FIXTURES <sup>(a)</sup>														
OCCUPANCY	WATER CLOSETS			LAVATORIES			TUBS / SHOWERS			DRINKING FOUNTAINS			OTHER (SERVICE SINK)	
	M	U	W	M	W	M	W	M	W	M	W	M	W	
BUSINESS (AREA "100")	1	<50%	1	1	1	0	0	1	0			1 <sup>(a)</sup>	0	
BUSINESS (AREA "200")	1	<50%	2	1	3	0	0	0	0	1	0		1 <sup>(a)</sup>	
SUBTOTAL	2	<50%	3	2	2	0	0	0	0	0	0	1	1	
GRAND TOTAL	5			4			0			2			2 <sup>(a)</sup>	
PROVIDED PLUMBING FIXTURES														
OCCUPANCY	WATER CLOSETS			LAVATORIES			TUBS / SHOWERS			DRINKING FOUNTAINS			OTHER (SERVICE SINK)	
	M	U	W	M	W	M	W	M	W	M	W	M	W	
BUSINESS (AREA "100")	1	0	1	1	1	0	0	1	1	0	0	0	0	
BUSINESS (AREA "200")	2	0	3	2	3	0	0	0	0	0	0	0	1	
SUBTOTAL	3	0	4	3	4	0	0	0	0	0	0	0	1	
GRAND TOTAL	7			7			0			0			1 <sup>(a)</sup>	
NOTES:														
a. AS PER IPC 403 (COMMENTARY) ONLY ONE (1) SERVICE SINK IS REQUIRED FOR THE ENTIRE BUILDING.														

CODE REQUIREMENTS		
OCCUPANCY CLASSIFICATION: B - BUSINESS		
CONSTRUCTION REQUIREMENTS: TYPE OF CONSTRUCTION (AS ALLOWED BY IBC TABLE 503): IBC TYPE IIIB, NOT SPRINKLERED (IBC 506.3) BUSINESS ALLOWABLE AREA: PER FLOOR 19,000 SF = 19,000 SF AREA OF AREA "100": 2,460 SF AREA OF AREA "200": 5,435 SF  SPRINKLER SYSTEM: PROJECT AREA IS NOT FULLY SPRINKLERED.		
OCCUPANCY LOAD: (LSC TABLE 7.3.1.2; IBC TABLE 1004.1.2) AREA "100" OCCUPANCY LOAD: 37 PERSONS AREA "200" OCCUPANCY LOAD: 99 PERSONS		
OCCUPANT LOAD FACTORS USED TO CALCULATE OCCUPANT LOADS ABOVE: (LSC TABLE 7.3.1.2; IBC TABLE 1004.1.2) CLASSROOMS: 20 NSF/PERSON OFFICES: 100 GSF/PERSON MECHANICAL, ELECTRICAL, DATA, STORAGE: 300 GSF/PERSON		
CONSTRUCTION PROTECTION: FIRE PROTECTION OF STRUCTURAL ELEMENTS: (IBC TABLE 601) STRUCTURAL FRAME: 0-HOUR, NONCOMBUSTIBLE BEARING WALLS: EXTERIOR BEARING WALLS 2-HOUR, NONCOMBUSTIBLE (EXCEPTION (a) PERMITS ONE (1) HOUR WHERE SUPORTING ROOF ONLY) INTERIOR BEARING WALLS 0-HOUR, NONCOMBUSTIBLE FLOOR CONSTRUCTION: 0-HOUR, NONCOMBUSTIBLE ROOF CONSTRUCTION: 0-HOUR, NONCOMBUSTIBLE		
FIRE PROTECTION OF BUILDING COMPONENTS: VERTICAL OPENINGS: N/A EGRESS CORRIDOR: 0-HOUR, NONCOMBUSTIBLE (LSC 38.3.6.1(3)) HAZARDOUS AREAS: 1-HOUR, NONCOMBUSTIBLE (LSC 8.7; 38.3.2; 6.2.2) HORIZONTAL EXITS: N/A		
MEANS OF EGRESS REQUIREMENTS:  CAPACITY OF MEANS OF EGRESS: (LSC TABLE 7.3.3.1) CAPACITY ASSUMES CLEARANCE IS TWO INCHES LESS THAN ACTUAL DOOR SIZE (E.G. 34 INCHES CLEAR AT A 36-INCH DOOR). THE NUMBER OF HORIZONTAL EXITS FROM ANY FIRE COMPARTMENT DOES NOT EXCEED 50% OF THE EXITS. THE CAPACITY OF EXITS OTHER THAN THE HORIZONTAL EXITS IS GREATER THAN 50% OF THE OCCUPANT LOAD.  AREA "100": 37 PERSON LOAD AREA "200": 99 PERSON LOAD 340 PERSON CAPACITY 850 PERSON CAPACITY  NUMBER OF EXITS PER FLOOR: (LSC 40.2.4; 38.2.4) AREA "100": 1 EXITS REQUIRED AREA "200": 2 EXITS REQUIRED 2 PROVIDED (SINGLE EXIT (38.2.4.3)) 5 PROVIDED  TRAVEL DISTANCE TO EXITS: (LSC 40.2.6; LSC 38.2.6) IN AN BUSINESS OCCUPANCY TRAVEL DISTANCE SHALL NOT EXCEED 200 FEET.  MAXIMUM DEAD END CORRIDORS: (LSC 40.2.5; LSC 38.2.5.2) IN AN BUSINESS OCCUPANCY THE DEAD END CORRIDOR LENGTH SHALL NOT EXCEED 20 FEET.  INTERIOR FINISHES: (LSC 40.3.3; LSC 38.3.3) INTERIOR WALLS AND CEILING FINISH: AT EXITS (BUSINESS ) CLASS A OR B ALLOWED AT OTHER THAN EXITS (BUSINESS ) CLASS A, B OR C ALLOWED CLASS A PROVIDED CLASS A OR B PROVIDED  INTERIOR FLOOR FINISH - NO REQUIREMENTS AT EXITS/AT OTHER THAN EXITS (BUSINESS ) CLASS I OR II ALLOWED CLASS I PROVIDED		

GENERAL INFORMATION	
PROPERTY ADDRESS:	CHATAM COUNTY COOPERATIVE CXTENSION SERVICES 17 MINUS AVENUE GARDEN CITY, GA 31408
GROSS ENCLOSED BUILDING AREA: PROPOSED RENOVATION (100): EXISTING OFFICE (200): TOTAL AREA:	2,460 SF 5,435 SF 7,895 SF
APPLICABLE BUILDING CODES WITH GEORGIA AMENDMENTS: (LIST IS NOT INCLUSIVE)	I. International Building Code, 2012 Edition, with Georgia Amendments (2014) (2015) II. International Fire Code, 2012 Edition, with Georgia Amendments (2014) III. International Plumbing Code, 2012 Edition, with Georgia Amendments (2014) (2015) IV. International Mechanical Code, 2012 Edition, with Georgia Amendments (2014) (2015) V. International Fuel Gas Code, 2012 Edition, with Georgia Amendments (2014) (2015) VI. National Electrical Code, 2014 Edition (No Georgia Amendments) VII. International Energy Conservation Code, 2009 Edition, with Georgia Supplements and Amendments (2011)(2012) VIII. Life Safety Code, NFPA 101, 2012 Edition with Georgia Amendments (2015) IX. Georgia Accessibility Code 2012 - DOJ 2010 ADA Standards for Accessible Design
LIFE SAFETY DISTANCES	
COMMON PATH OF TRAVEL (XX.FT. MAX)	0' - 3'
DEAD END CORRIDOR (XX.FT. MAX)	0' - 3'
TRAVEL DISTANCE	
MAX DIAGONAL DISTANCE	0' - 3'
EXIT SEPARATION	0' - 3'
LIFE SAFETY LEGEND	
	NUMBER IN DIAMOND INDICATES NUMBER OF OCCUPANTS IN ANY SPACE CALCULATED FROM LOAD FACTORS (LSC/IBC)
	SPACE CONSIDERED AS BEING UNOCCUPIED AND NOT INCLUDED WITH IN CALCULATIONS
	SPACE CONSIDERED AS BEING OCCUPIED AND INCLUDED IN CALCULATIONS
	NUMBER IN OCTAGON INDICATES NUMBER OF ACTUAL OCCUPANTS IN SPACE
	NUMBER IN CIRCLE INDICATES EGRESS CAPACITY OF OPENING
	20-MINUTE FIRE-RATED DOOR ASSEMBLY
	45-MINUTE FIRE-RATED DOOR ASSEMBLY
	1-HOUR FIRE-RATED DOOR ASSEMBLY
	1-1/2 HOUR FIRE-RATED DOOR ASSEMBLY
	EXIT/AREA OF REFUGE LIGHT
	FIRE EXTINGUISHER CABINET
	FIRE EXTINGUISHER BRACKET
NOTE: REFER TO ELECTRICAL DRAWINGS FOR ADDITIONAL LIFE SAFETY INFORMATION	

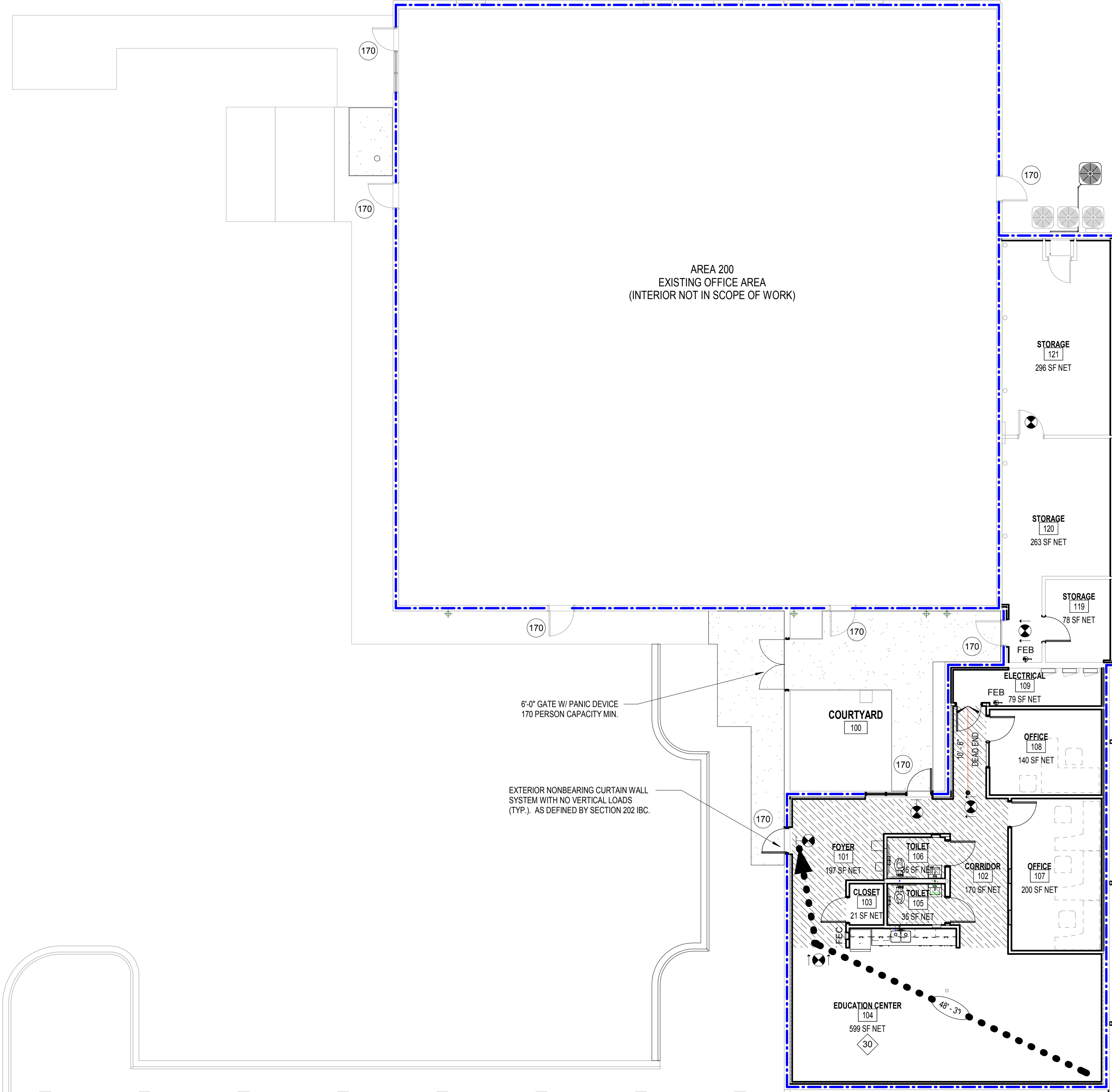

TYPE IIIB CONSTRUCTION FIRE-RESISTANCE RATING REQUIREMENTS	
PRIMARY STRUCTURAL FRAME	0 HOUR
BEARING WALLS	
EXTERIOR	2 HOUR*
INTERIOR	0 HOUR
NONBEARING WALLS & PARTITIONS	
EXTERIOR	0 HOUR
INTERIOR	0 HOUR
FLOOR CONSTRUCTION	N/A
ROOF CONSTRUCTION	0 HOUR
*CHAPTER 6 OF IBC - TABLES 601 & 602 (SEE EXCEPTION "A" FOR 1 HOUR REDUCTION)	
FIRE-RESISTANCE RATING REQUIREMENTS LEGEND	
	2 HOUR FIRE-RESISTIVE RATING FOR BUILDING ELEMENTS IN ACCORDANCE WITH TABLE 601
	1 HOUR FIRE-RESISTIVE RATING FOR BUILDING ELEMENTS IN ACCORDANCE WITH TABLE 601

CHATHAM COUNTY COOPERATIVE  
EXTENSION SERVICE  
REHABILITATION  
17 MINUS AVENUE  
CHATHAM COUNTY, GEORGIA  
CONSTRUCTION DOCUMENTS

CogdellMendralaArchitects  
COGDELL & MENDRALA ARCHITECTS, PC  
517 EAST CONGRESS STREET  
SAVANNAH, GEORGIA 31401  
tel 912.234.6318  
fax 912.236.8414  
cogdellmendrala.com

SEAL:

PROJECT CONSULTANTS:  
MECHANICAL, ELECTRICAL, &  
PLUMBING ENGINEER:  
**SUSTAINABLE DESIGN CONSULTANTS**  
415 BONAVENTURE ROAD  
SAVANNAH, GA. 31404

KEY PLAN:

SHEET TITLE:  
**LIFE SAFETY - COMPOSITE FIRST FLOOR PLAN**

REVISION SCHEDULE  

DATE	DESCRIPTION
6/6/19	Addendum 1

PROJECT NO: 1823  
DATE: APRIL 2019  
DRAWN BY: CBS  
SCALE: As indicated

SHEET: **LS1.01**

MINIS AVE

PIN 6-0016-01-009



CHATHAM COUNTY COOPERATIVE EXTENSION SERVICE

PLOT PLAN

Cogdell Mendrala Architects

PROJECT NO:

1823

DATE:

APRIL 2019

SCALE:

1" = 20'-0"



SHEET:

PP-01



GENERAL NOTES

1

REFERENCE THE CODE INFORMATION ON SHEET L50.01 FOR LIFE SAFETY REQUIREMENTS.

2

REFER TO SHEET A0.01 FOR SYMBOL LEGEND.

3

FRAME WALL DIMENSIONS ARE TO FACE OF STUD (UNO)

4

MASONRY WALL DIMENSIONS ARE TO FACE OF CMU (UNO)

5

EXTERIOR CONCRETE SIDEWALK SURFACE SHALL SLOPE AWAY FROM THE BUILDING AT 1/4" PER FOOT MINIMUM FOR A DISTANCE OF 6'-0" MINIMUM. BEYOND 6'-0" THEY SHALL SLOPE AWAY FROM THE BUILDING AT 1/8" PER FOOT MINIMUM TO 1/2" PER FOOT MAXIMUM. REFER TO CIVIL DRAWINGS FOR EXTENT OF SIDEWALKS AND SPOT ELEVATIONS.

6

PROVIDE SOUND ATTENUATION BATTS OVER CEILINGS OF ALL SINGLE USER TOILET ROOMS, ALL OFFICES, AND ALL CONFERENCE ROOMS. PROVIDE 4'-0" WIDTH OF SOUND ATTENUATION BATTS (S.A.B.) OVER CEILINGS OF CLASSROOMS ADJACENT TO PARTITION WALLS THAT DO NOT EXTEND TO THE DECK ABOVE.

7

OFFSET DOOR FRAMES IN STUD PARTITIONS 4" FROM ADJACENT WALL UNLESS INDICATED OTHERWISE.

8

OFFSET DOOR FRAMES IN MASONRY WALLS 8" FROM ADJACENT MASONRY WALL UNLESS OTHERWISE NOTED.

9

LOCATE CONTROLS FOR MECHANICAL, ELECTRICAL, & LIFE SAFETY SYSTEMS (SWITCHES, THERMOSTATS, PULL STATIONS, ETC) WITHIN 12" OF NEAREST CORNER OR OPENING. DO NOT CENTER ITEM ON WALL. COORDINATE WITH ARCHITECT IF QUESTIONS ARISE. REFER TO ELECTRICAL FOR DETAILS.

10

WHERE A NOTE/DETAIL IS SHOWN FOR ONE CONDITION, IT SHALL APPLY TO ALL SIMILAR AND LIKE CONDITIONS UNLESS NOTED OTHERWISE.

11

REFER TO MECHANICAL DRAWINGS FOR ADDITIONAL INFORMATION REGARDING WALL OPENINGS FOR LOUVERS AND GRILLES.

12

REFER TO SHEET A5.01, ENLARGED PARTIAL FLOOR PLANS AND INTERIOR ELEVATIONS FOR LOCATIONS OF TOILET ACCESSORIES.

13

REFER TO PLANS AND/OR SECTIONS FOR SUBSYSTEM TYPE

14

ALL EXPOSED, UNREFINISHED EXTERIOR METAL SURFACES SHALL BE PAINTED.

15

INSTALL WOOD BLOCKING BEHIND ALL WALL-MOUNTED EQUIPMENT AT STUD PARTITIONS AND FURNING.

16

NEW FINISHES SHALL BE INSTALLED FLUSH WITH EXISTING FINISHES.

17

ALL NEW EXTERIOR MASONRY TO "TOOTH" INTO EXISTING BRICK AND CMU.

KEYNOTE LEGEND - MASTER

NO.

NOTE

04 20 00.04

8" CMU

05 12 00.C26

C4X5.4

06 10 53.A2

WD. BLOCKING AS REQD.

06 10 53.B1

1X NAILER

06 10 53.B3

P.T. 1X NAILER

06 10 53.C9

2X4 FRAMING @ 16" O.C.

06 10 53.C13

2X4 STUDS @ 24" O.C.

06 10 53.D7

2X6 STUDS @ 16" O.C.

06 40 23.B2

THRESHOLD SOLID SURFACE MATL.

06 40 23.B6

SOLID SURFACE WINDOW STOOL

06 40 23.B16

SOLID SURFACE MATERIAL COUNTERTOP WITH INTEGRAL SINK

06 40 23.C3

3/4" PARTICLE BOARD TOP & SIDES

06 40 23.C6

3/4" PARTICLE BOARD ADJUSTABLE SHELF W/ SOLID NOSING

06 40 23.C7

3/4" PARTICLE BOARD BOTTOM

06 40 23.C8

3/4" PARTICLE BOARD BOTTOM W/ SOLID NOSING

06 40 23.C12

3/4" PARTICLE BOARD DRAWER FRONT W/ PULL

06 40 23.C17

RECESSED METAL STANDARDS, TYP.

06 40 23.C21

1/2" PARTICLE BOARD BACK

06 40 23.C37

3/4" MARINE GRADE PLYWOOD

06 40 23.E2

2X P.T. SLEEPER TYP.

07 14 16

COLD FLUID-APPLIED ROOFING

07 21 00

THERMAL INSULATION

07 21 00.B1

INSULATION NETTING

07 21 00.C1

RIGID INSULATION

07 41 13.16

STANDING-SEAM METAL ROOF PANELS

07 41 13.D2

METAL SOFFIT PANELS

07 41 13.F

BRAKE METAL

07 42 43.A2

SELF-ADHERING UNDERLAYMENT

07 54 19

POLY-VINYL CHLORIDE ROOFING

07 54 19.B

PVC FLASHING

07 54 19.C4

POLYISO INSULATION

07 54 19.D1

PVC COATED FLASHING METAL

07 54 23.D10

MANUFACTURED DRIP EDGE

07 62 00.E

DOWNSPOUT

07 62 00.H

5" X 5" METAL GUTTER

07 92 00

JOINT SEALANTS

07 92 00.A6

SEALANT AND BACKER ROD

07 92 00.A8

SEALANT, CONTINUOUS BOTH SIDES

07 92 00.A9

BACKER ROD WITH SEALANT CONTINUOUS BOTH SIDES

07 92 00.A13

CONTINUOUS SEALANT

07 92 00.A14

BUTYL JOINT SEALANT

07 92 00.A15

BUTYL TAPE SEALANT

08 11 13.A

HMI FRAME

08 11 13.A2

FRAME ANCHOR (3) PER JAMB

08 11 13.A4

GLASS STOP

08 41 13

ALUMINUM-FRAMED ENTRANCES & STOREFRONTS

08 41 13.C

STOREFRONT FRAMING

08 41 13.C1

SHIM

08 41 13.C3

3/80 MIN. BRAKE METAL, MATCH FINISH OF STOREFRONT

08 44 13.C

SHIM

08 60 00

GLAZING

09 22 16.D

3/8" METAL STUD FRAMING

09 22 16.D2

3/8" METAL STUDS @ 16" O.C.

09 22 16.M1

L.G. METAL FRAMING HEADER

09 22 16.M2

(2) 16 GA. METAL STUDS @ OPENING

09 22 16.C6

2 1/2" LIGHT GAUGE ZEE FURRING AT 16" O.C.

09 24 00.A2

1/2" DIRECT APPLIED PORTLAND CEMENT PLASTER

09 29 00.A5

5/8" GYPSUM BOARD

09 29 00.D1

1 LAYER 5/8" GYPSUM BOARD

09 29 00.F2

5/8" CEMENTITIOUS BACKING

09 29 00.H1

CORNER BEAD

09 29 00.H4

ACOUSTICAL INSULATION

09 30 00

TILING

09 30 00.A3

FLOOR TILING

09 51 00

ACOUSTICAL CEILINGS

09 51 13.A

APC 2 X 2

09 51 13.C

GRID SYSTEM

09 51 13.E3

EDGE ANGLE

09 65 19

RESILIENT TILE FLOORING

11 31 00.A

REFRIGERATOR

32 31 13.F4

CHAIN LINK FENCING

GRAPHIC SYMBOLS

DWG NO.

1

TITLE OF DRAWING

A0.1

1/8" = 1'-0"

BUILDING SECTION

DWG NO.

1

SHEET NO. WHERE SECT. IS DRAWN

1

SECT. LINE

WALL OR SECTION DETAIL

DWG NO.

1

SHEET NO. WHERE SECT. IS DRAWN

1

SECT. LINE

PLAN OR SECTION DETAIL

DWG NO.

1

SHEET NO. WHERE DET. IS DRAWN

1

DASHES AROUND AREA DETAILED

EXTERIOR ELEVATION

DRAWING NO.

1

SHEET NO. WHERE ELEV. IS DRAWN

1

4

2

3

INTERIOR ELEVATION

DRAWING NO.

1

SHEET NO. WHERE ELEV. IS DRAWN

1

4

2

3

NORTH ARROW

N

0

180

ROOM NAME & NUMBER

LOBBY

1100

ROOM NAME

ROOM NO.

DOOR NUMBER

100A

DOOR NO.

CONSTRUCTION SUBSYSTEM (ROOF)

SEE A1.0

1

ROOF TYPE

CONSTRUCTION SUBSYSTEM (FLOOR)

SEE A1.0

1

FLOOR TYPE

PARTITION TYPE (WALL)

SEE A1.0

1

WALL TYPE

GLAZED OPENING TYPE (CURTAIN WALL)

SEE A8.X SERIES

1

C1

GLAZED OPENING TYPE (STOREFRONT)

SEE A8.X SERIES

1

S1

GLAZED OPENING TYPE (WINDOW)

SEE A8.X SERIES

1

W1

CENTER LINE

---

MATCH LINE

---

BREAK LINE

---

DIMENSION INDICATOR

16'-0"

SPOT ELEVATION

0'-0"

VERTICAL HEIGHT

0'-0"

BATHROOM ACCESSORY

TBA-1

PLAN KEYNOTE

03 30 00.A

C

CAST-IN-PLACE CONCRETE

CONSTRUCTION COMPONENT AS LISTED IN LEGEND

REVISION

1

REVISION CLOUD

2

REVISION NUMBER

PLAN NOTES

1

REFERS TO CORRESPONDING NOTES ON SHEET

ABBREVIATIONS

A/C

AIR CONDITION(ING)

ADMIN

ADMINISTRATION

AFF

ABOVE FINISHED FLOOR

ALT

ALTERNATE

ALUM

ALUMINUM

APPROX

APPROXIMATE(LY)

ARCH

ARCHITECT(URAL)

AUTO

AUTOMATIC

AUX

AUXILIARY

AV

AUDIOVISUAL

BITUM

BITUMINOUS

BL

BUILDING LINE

BLDG

BUILDING

BOS

BOTTOM OF STEEL

BOT

BOTTOM

CAB

CABINET

CJ

CONTROL JOINT

CL

CENTER LINE

CLG

CEILING

CLG HT

CEILING HEIGHT

CLO

CLOSET

CLR

CLEAR(ANCE)

CMU

CONCRETE MASONRY UNIT

COL

COLUMN

CONC

CONCRETE

CONF

CONFERENCE

CONT

CONTINUE, CONTINUOUS

CORR

CORRIDOR

CU FT

CUBIC FOOT

CU YD

CUBIC YARD

DEMOL

DEMOLISH

DEPT

DEPARTMENT

DET

DETAIL

DF

DRINKING FOUNTAIN

DIA

DIAMETER

DIAG

DIAGONAL

DIM

DIMENSION

DIV

DIVISION

DS

DOWN SPOUT

E

EAST

EA

EACH

EL

ELEVATION

ELEC

ELECTRIC(AL)

ELEV

ELEVATOR

EJ

EXPANSION JOINT

ENCL

ENCLOSE(D)

EQ

EQUAL

EQ

EQUAL

EQU

EQUIPMENT

EW

ELECTRIC WATER COOLER

EXIST

EXISTING

EXP JT

EXPANSION JOINT

EXT

EXTERIOR

FD

FLOOR DRAIN

FE

FIRE EXTINGUISHER

FEB

FIRE EXTINGUISHER ON BRACKET

FEC

FIRE EXTINGUISHER CABINET

F/F

FACE TO FACE

FF EL

FINISH FLOOR ELEVATION

FHC

FIRE HOSE CABINET

FIN FLR

FINISHED FLOOR

FLR

FLOOR, FILLER

FOC

FACE OF CURB

FOF

FACE OF FINISH

FOM

FACE OF MASONRY

FOS

FACE OF SLAB

FOW

FACE OF WALL

FOOT, FEET

FOOT, FEET

FTG

FOOTING

FURN

FURNISH, FURNITURE

GA

GAGE

GALV

GALVANIZED

GC

GENERAL CONTRACTOR

GYP BD

GYPSUM BOARD

GYP PLAS

GYPSUM PLASTER

HC

HANDICAP

HD

HEAVY DUTY

HDWR

HARDWARE

HDWD

HARDWOOD

HORIZ

HOLLOW METAL

HT

HEIGHT

HVAC

HEATING, VENTILATION & AIR CONDITIONING

ID

INFO

INCL

INCLUDE(D), (ING)

INSUL

INSULATION

INT

INTERIOR

JAN CLO

JANITOR CLOSET

KIT

KITCHEN

KO

KNOCKOUT

LAB

LABORATORY

LAM

LAMINATE

LAU

LAUNDRY

LAV

LAV LAVATORY

LF

LF LINEAR FEET

LVR

LVR LOUVER

MAINT

MAINTENANCE

MATL

MATERIAL

MAX

MAXIMUM

MECH

MECHANICAL

MEZZ

MEZZANINE

MFG

MANUFACTURING

MFR

MANUFACTURER

MIN

MINIMUM

MISC

MISCELLANEOUS

MO

MASONRY OPENING

MR

MOISTURE RESISTANT

MTD

MOUNTED

MTG

MOUNTING

MTL

METAL

N

NORTH

NIC

NOT IN CONTRACT

NON

NON-COMBUSTIBLE

NOM

NOMINAL

NTS

NOT TO SCALE

OC

ON CENTER

OD

OUTSIDE DIAMETER

OPT

OPTIONAL

OPP

OPPOSITE

PCF

POUNDS PER CUBIC FEET

PLAM

PLASTIC LAMINATE

PLF

POUNDS PER LINEAR FOOT

PLYWD

PLYWOOD

PNL

PANEL

PR

PAIR

PREFAB

PREFABRICATED

PREFIN

PREFINISH

PRKG

PARKING

PSF

POUNDS PER SQUARE FOOT

PSI

POUNDS PER SQUARE INCH

PT

PAINT, POST-TENSIONED, PRE-TREATED

PVC

POLYVINYL CHLORIDE (PLASTIC)

QTR

QUARTER

QTY

QUANTITY

R

RADIUS, RISER

RCP

REFLECTED CEILING PLAN, REINFORCED CONCRETE

RD

ROOF DRAIN

REF

REFRIGERATOR, REFERENCE

REQD

REQUIRED

RL

ROOM LEADER

RM

ROOM

RO

ROUGH OPENING

ROW

RIGHT OF WAY

S

S SOUTH

SC

SC SOLID CORE

SD

SD STORM DRAIN

SECT

SECTION

SF

SF SQUARE FEET

SIM

SIM SIMILAR

SPEC

SPEC SPECIFICATION

SPKR

SPKR SPEAKER

SQ

SQ SQUARE

SS

SS STAINLESS STEEL

STD

STANDARD

STOR

STORAGE

SUSP

SUSPENDED

SYS

SYSTEM

T

TREAD

TEL

TELEPHONE

TEMP

TEMPORARY

TFF

TOP OF FINISH FLOOR

THK

THICKNESS

THRU

THROUGH

TO

TOP OF

TOB

TOP OF BEAM

TOC

TOP OF CONCRETE, TOP OF CURB

TOF

TOP OF FOOTING

TOJ

TOP OF JOIST

TOM

TOP OF MASONRY

TOP

TOP OF PARAPET

TOS

TOS TOP OF SLAB

TOW

TOW TOP OF WALL

TRTD

TRTATED

TV

TELEVISION

TYP

TYPICAL

UL

UNDERWRITERS LABORATORIES

UNO

UNLESS NOTED OTHERWISE

VERT

VERTICAL

VEST

VESTIBULE

VIF

VERIFY IN FIELD

W

WEST, WIDE

W/

WITH

W/O

WITHOUT

WC

WATER CLOSET

WD

WOOD

WP

WORKING POINT, WATERPROOFING

WR

WATER REPELLENT

WT

WEIGHT

W/W

WALL TO WALL

WWF

WELDED WIRE FABRIC

YD

YARD

6/6/2019 1:27:14 PM C:\Users\studd\Documents\1823 COOP EXT SERV 2019\_rudd.rvt

CHATHAM COUNTY COOPERATIVE

EXTENSION SERVICE

REHABILITATION

17 MINUS AVENUE

CHATHAM COUNTY, GEORGIA

CONSTRUCTION DOCUMENTS

COGDELL MENDRALA ARCHITECTS

COGDELL & MENDRALA ARCHITECTS, PC

517 EAST CONGRESS STREET

SAVANNAH, GEORGIA 31401

tel 912.234.6318

fax 912.236.8414

cogdellmendrala.com

SEAL:

STATE OF GEORGIA

REGISTERED ARCHITECT

Casey Brent Smith

PROJECT CONSULTANTS:

MECHANICAL, ELECTRICAL, & PLUMBING ENGINEER:

**SUSTAINABLE DESIGN CONSULTANTS**

415 BONAVENTURE ROAD

SAVANNAH, GA. 31404

KEY PLAN:

N

0

180

SHEET TITLE:

GEN. PROJECT NOTES, GRAPHIC SYMBOLS, & ABBREVIATIONS

REVISION SCHEDULE

DATE

DESCRIPTION

6/6/19

Addendum 1

PROJECT NO:

1823

DATE:

APRIL 2019

DRAWN BY:

RML

SCALE:

As indicated

SHEET:

A0.01