

**GD&T**

**DISTRICT 5**

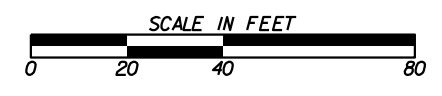

REVISION DATES		SIGNING AND MARKING PLANS	
		1-16 & SR 17/BLOOMINGDALE INTERSECTION	
		ROUNDAABOUTS, CHATHAM COUNTY	
CHECKED:	DATE:	DRAWING No.	
BACKCHECKED:	DATE:	26-0001	
CORRECTED:	DATE:		
VERIFIED:	DATE:		

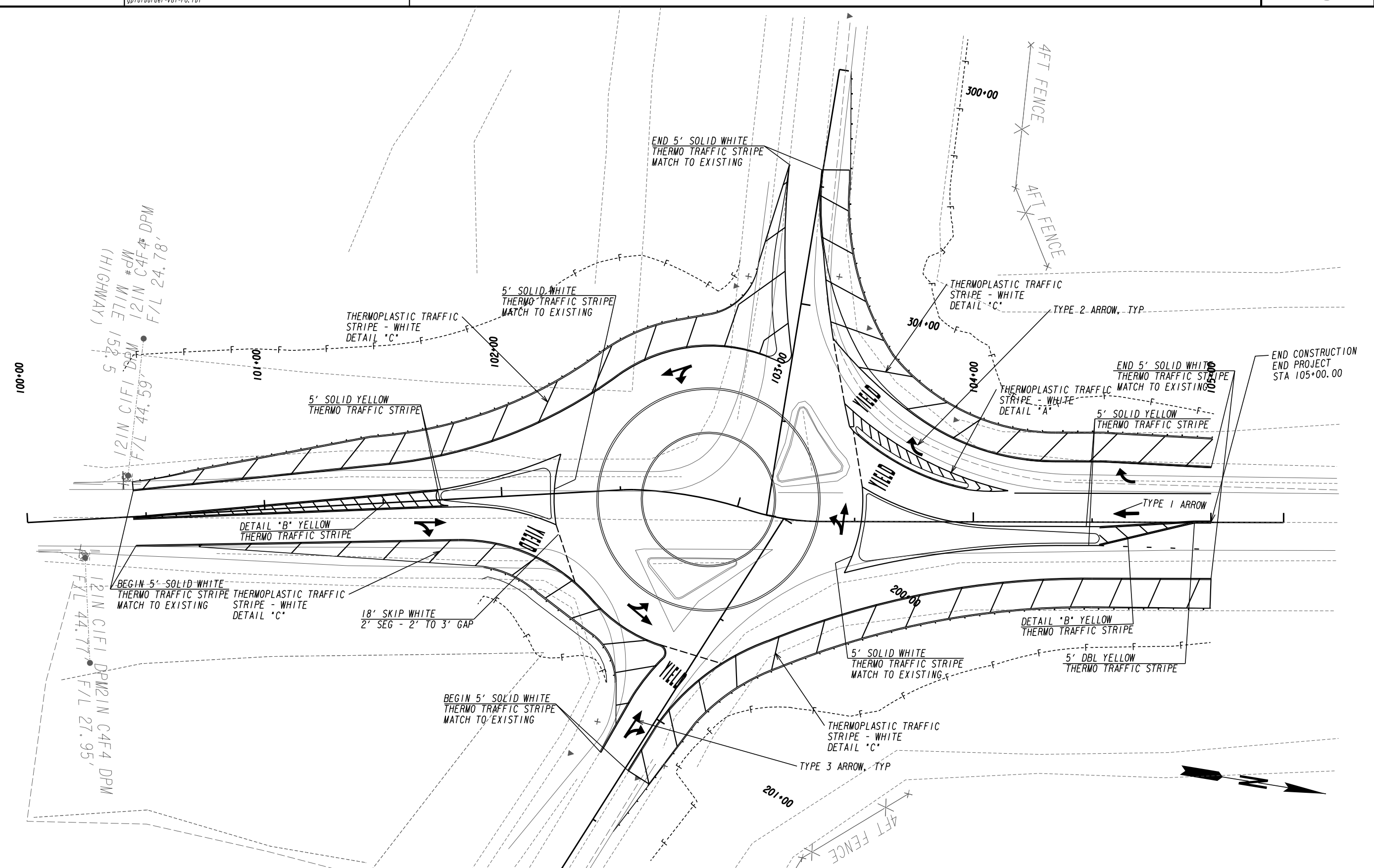

**GD&T**

**DISTRICT 5**

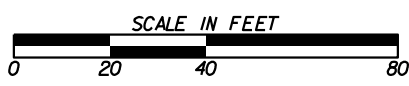

REVISION DATES		SIGNING AND MARKING PLANS	
		I-16 & SR 17/BLOOMINGDALE INTERSECTION	
		ROUNDAABOUTS, CHATHAM COUNTY	
CHECKED:	DATE:	DRAWING No.	
BACKCHECKED:	DATE:	26-0002	
CORRECTED:	DATE:		
VERIFIED:	DATE:		

